

OPTICAD - Computer Aided Design

OPTICAD addresses the essential need for integrated CAD/CAM functionality with its sophisticated, user-friendly system. Products in the glass industry continually increase in complexity in terms of shaped glass usage and processes. New generation machinery with direct CNC interfaces requires a direct link to accurate data in order to realise its full potential.

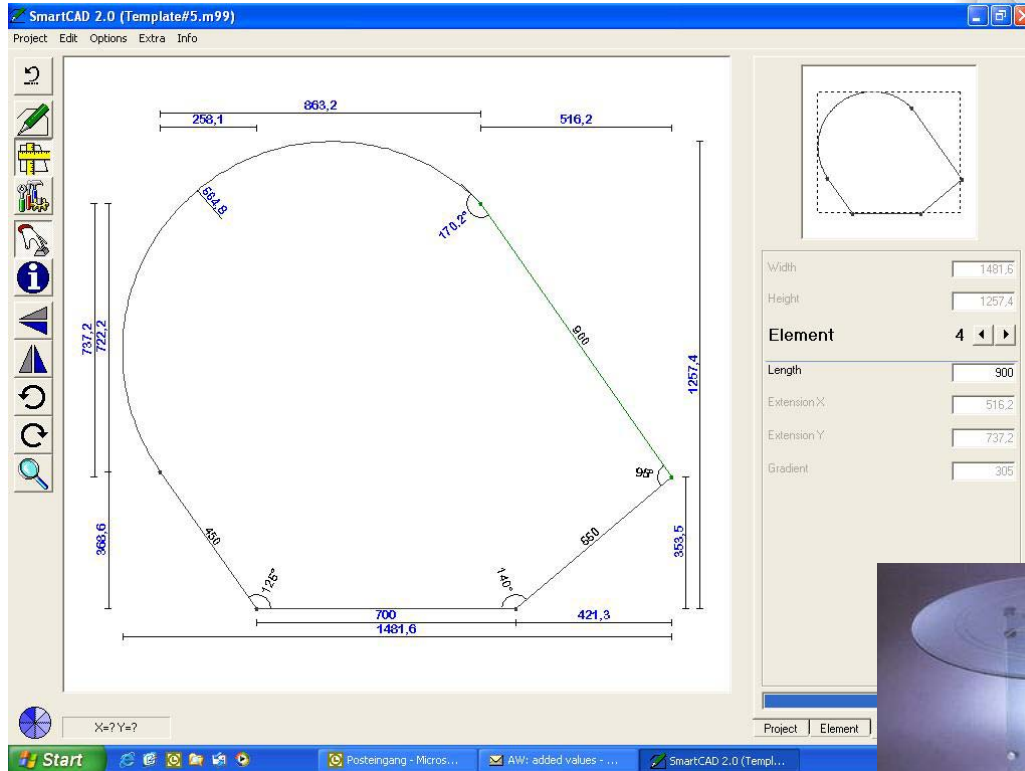
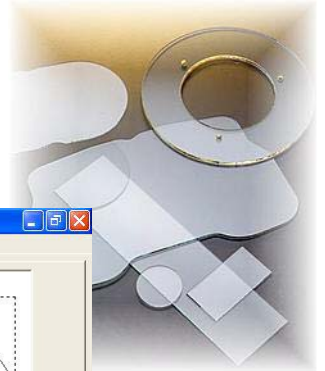

OPTICAD - a modular, state-of the art CAD/CAM system with an intuitive and concise user interface offers the following functionality:

- CAD for standard shapes
- CAD for complex glass processing
- CAD for Georgian bar construction
- CAD for stepped units



OPTICAD handles shapes from different sources. A standard catalogue is provided that covers most commonly used shapes. An integrated tool called **SmartCAD** allows the user to create individual shapes with just a few mouse clicks and then add it to the catalogue. Easy dimensioning and true-to-scale display with a printing option, communicate accurate information to both production and the customer. DXF file shape import functions interface to external applications.

As today's industry increases its use of electronic order entry (EDI) this important function enables the user to provide customers with shape data in DXF format (especially in the window and door industry) for online ordering.

- Corner and edge cut outs, round and slant corners, edge bows, drilling, fan holes, speak-holes

- All standard edge processes, mitres and bevels

- Stamps, handles, screen printing

- True-to-scale shape sketches for both customer and own production usage
- Overview sketch including cross section as single drawing (cutting and processing)
- Automatic output of detail sketches for counter-sunk drillings, mitred and bevelled edges

- Full integration with **OPTIPLUS/OPTIFER**

OPTICAD supports insulated glass manufacturers with an intuitive user interface which will accommodate complex constructions. **OPTICAD** assists sales personnel when entering Georgian constructions ranging from symmetric, single colour and profile grids up to shapes, multicolour constructions with varied profile widths.

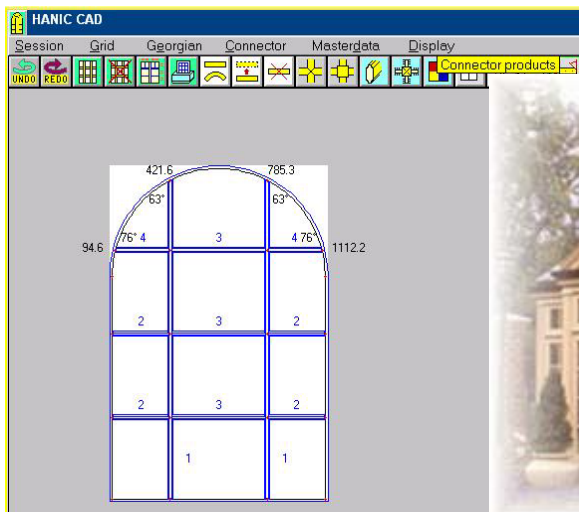
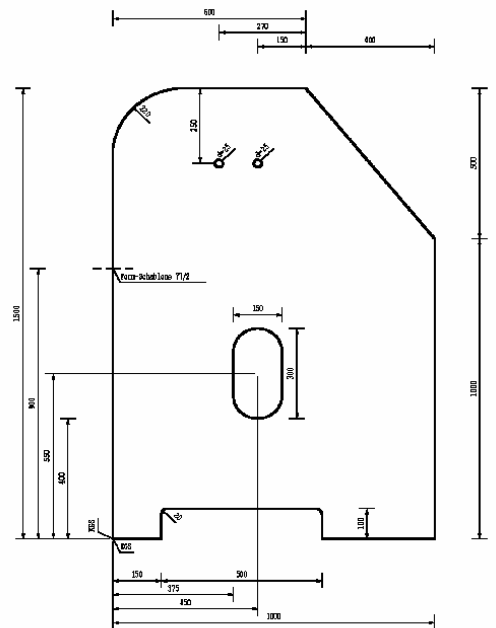



Functions

- Construction of symmetric and asymmetric grids in rectangular and shaped units
- Construction of angular or bent profiles with different calculation methods
- Construction of complex grids and profile shapes
- Construction in stepped units and processed shapes
- Rotation, movement or deletion of profiles

Sketches

- Customer and production sketch
- Bill of material, production technical dimensioning including spacer bar data
- Visualisation of field dimensions using various symmetry details, drilling points, co-ordinates, profile lengths



CAD for Stepped Units

OPTICAD offers a user-friendly tool capable of handling the most complicated stepped units. With an increasing degree of complexity required regarding construction and the stepped unit contingency constantly increasing, **OPTICAD** is an indispensable and necessary tool ensuring secure control of the production process. This results in the promotion of competency and increases market potential.

Functions

- Several construction methods which may be applied to single edges or contour areas: parallel or arbitrary movement, replacement or deletion of contour areas
- Stepped construction (inner/outer) depending on the requirement
- Construction of Z-steps in rectangular or shaped units
- Stepped construction, including laminated glass

Sketches

- Customer and production sketch
- Overview (construction) sketch with cross section, dimensioning of steps and indication on spacer bar, single sketch (cutting and processing) with production relevant dimensioning

Interfaces

- Full integration in **OPTIPLUS/OPTIFER**
- Stand-alone version

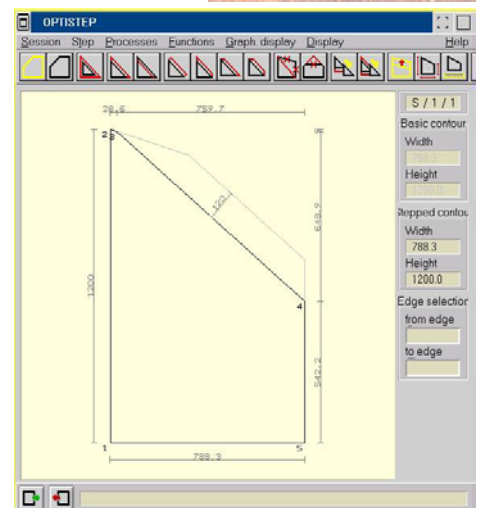

Enhanced functionality :

- Plausibility check
- Intuitive user interface in modern Windows based design
- True-to-scale graphical presentation
- UNDO functions, even after the information is saved
- Interface to external systems via standard ASCII file interface
- Import/Export functions to DXF, GEO format
- CNC Links to processing centers (Intermac, Bavelloni)
- CNC Links to drilling equipment (Forvet, Benteler)

HANIC GMBH

Auf der Reihe 2

45884 Gelsenkirchen

Germany

Tel. +49 209 9476-0

Fax +49 209 9476-199

www.hanic.de